

NO SIGNS TO BE PLACED ON FOOT PATHS

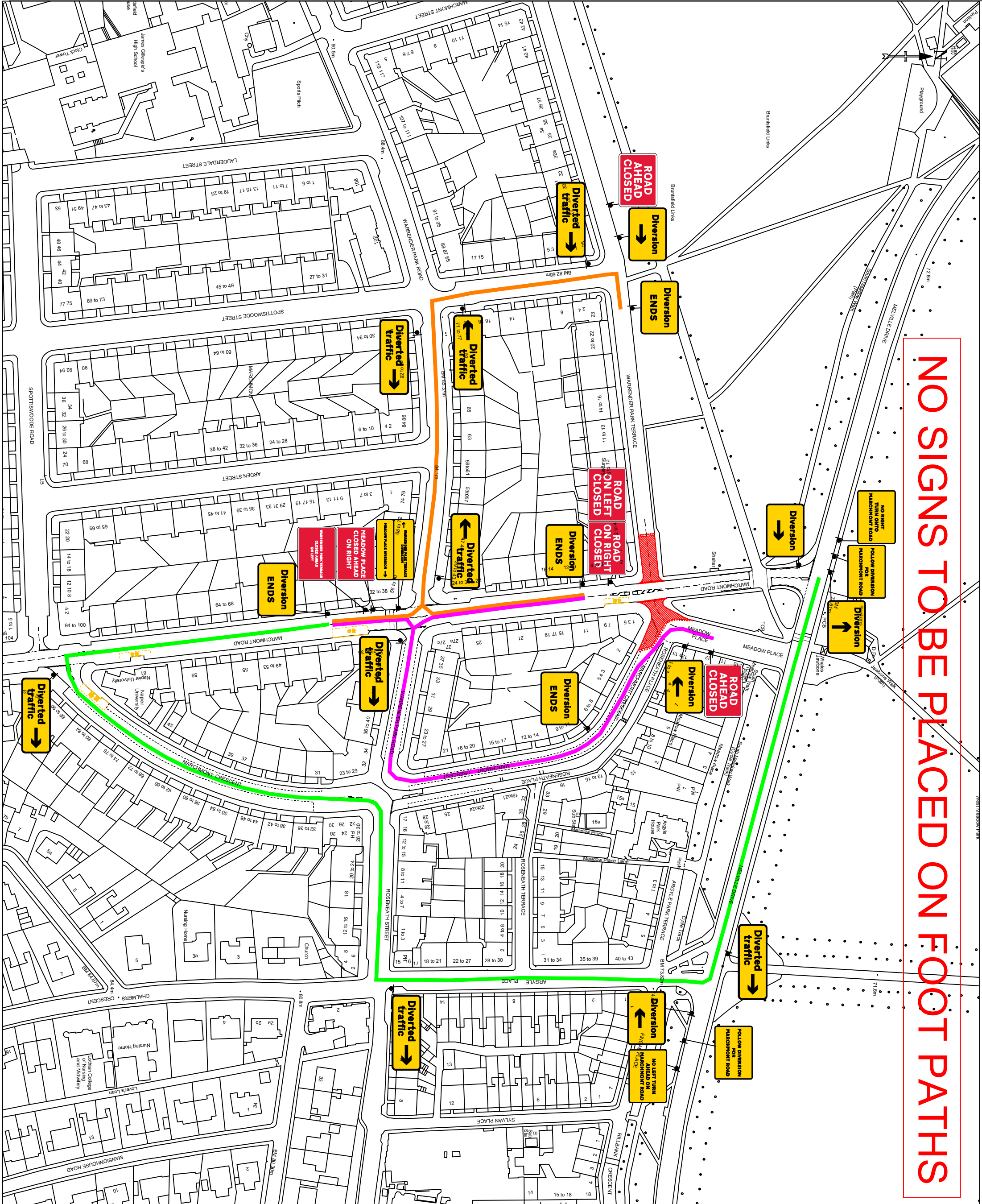

Design Parameters

Road Type	B
Speed Limit	20 mph
Road Width	9 m
Longitudinal Safety Zone	0.5 m
Sideways Safety Zone	0.5 m
Taper Length (if applicable)	N/A
Remaining Road Width	3.65 m
Distance to First Sign	45 m
Parking requires suspension	Y
Bus Stops Affected	Y
Permanent Signals Affected	Y

- Traffic Management Notes:**
- All temporary traffic management shall be in accordance with Chapter 7 of the Traffic Signs Manual 2009.
 - All temporary traffic management shall be in accordance with the Traffic Signs Regulations and General Directions 2016.
 - All traffic signs, signals, and general directions shall be placed at Street Works & Road Works: A Code of Practice 2013.
 - All temporary traffic management signs should be located 450m, minimum from the kerb face.
 - All temporary traffic management sign locations are indicative and are subject to on-site approval from the person in Charge.

- Legend:**
- Sign Face
 - Cone
 - Road Closure
 - Diversion Route 1
 - Diversion Route 2
 - Diversion Route 3

NO.	REVISION	DATE

Client: **CALEDONIA WATER ALLIANCE**
Edinburgh
EH9 1HX

Site Address: **Marchmont Road**
Edinburgh
EH9 1HX

Project: **SW/102 - Marchmont Road - CWA**

Title: **Road Closure**

Job No.	1102	Drawn	L.Cornion	Date	22/06/23
Designed	L.Cornion	Checked	C.McCann	Date	22/06/23
Scale	N.T.S.	Approved	DATE	DATE	

Dwg. No. **SW-1120** Revision **B**

-001.3

NHSS National Highway Safety Agency

CEF CONSTRUCTION FEDERATION